

Name \_\_\_\_\_

Date \_\_\_\_\_

1. Determine the perimeter and area of rectangles A and B.

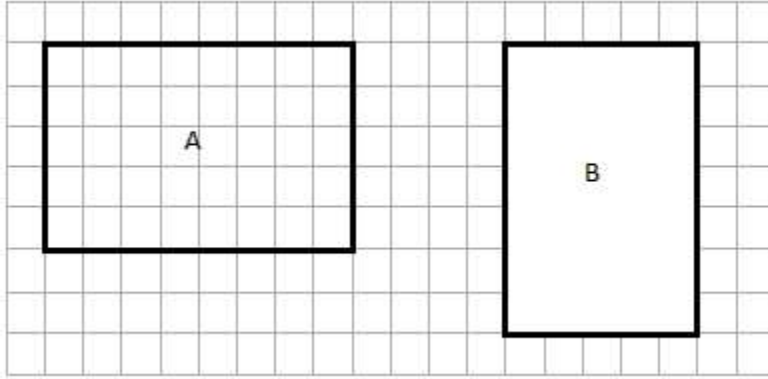

a.  $A =$  \_\_\_\_\_

$A =$  \_\_\_\_\_

b.  $P =$  \_\_\_\_\_

$P =$  \_\_\_\_\_

2. Determine the perimeter and area of each rectangle.

a.

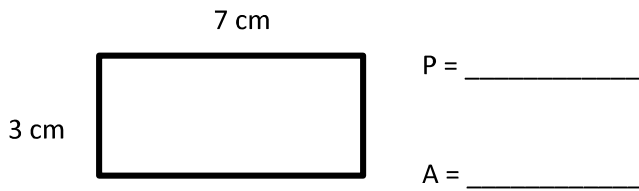

b.

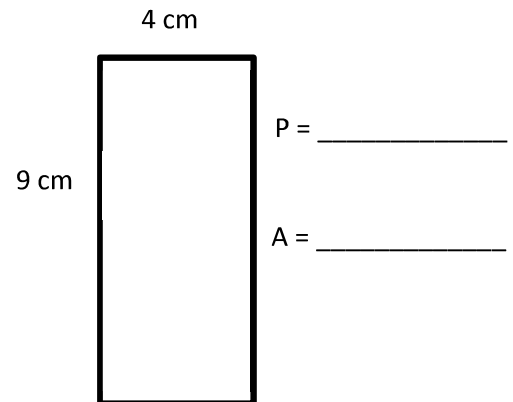

3. Determine the perimeter of each rectangle.

a.

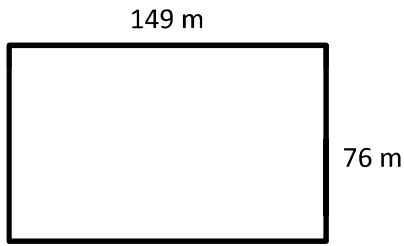

P = \_\_\_\_\_

b.

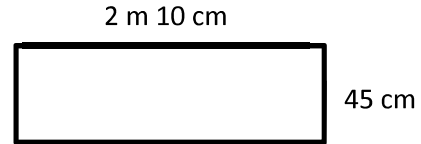

P = \_\_\_\_\_

4. Given the rectangle's area, find the unknown side length.

a.

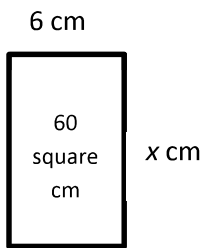

x = \_\_\_\_\_

b.

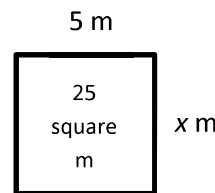

x = \_\_\_\_\_

5. Given the rectangle's perimeter, find the unknown side length.

a.  $P = 180$  cm

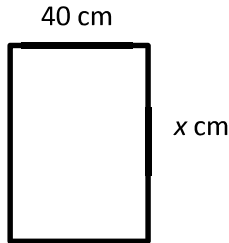

$x =$  \_\_\_\_\_

b.  $P = 1,000$  m

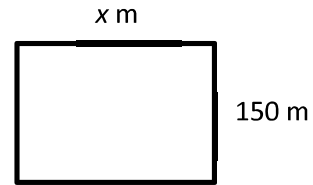

$x =$  \_\_\_\_\_

6. Each of the following rectangles has whole number side lengths. Given the area and perimeter, find the length and width.

a.  $A = 32$  square cm  
 $P = 24$  cm

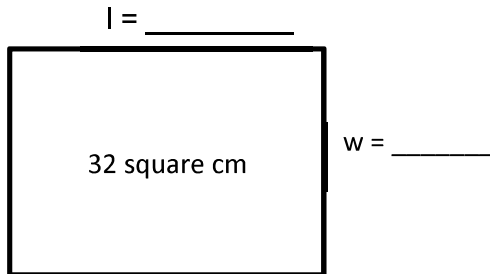

b.  $A = 36$  square m  
 $P = 30$  m

